

## BURST PORT FRAC VALVES

### APPLICATION

The Burst Port Fracturing Sleeve is designed to perform multistage fracturing using selective packer in cemented/open-hole wells. The tool can also be used as the sleeve for the first fracturing stage. The frac port is opened by pressurizing the liner interval at the depth of the sleeve.

### DESIGN FEATURES AND ADVANTAGES

- Using the sleeve in conjunction with selective packer allows for an unlimited number of fracturing stages;
- Ability to work in both cemented and uncemented completions;
- The tool design ensures 100% opening of the entire area of the frac ports;
- The inner diameter of the tool corresponds to the inner diameter casing;
- The tool can be installed in cemented and uncemented completions;
- The material grade of the tool corresponds to the casing grade P-110 (M).

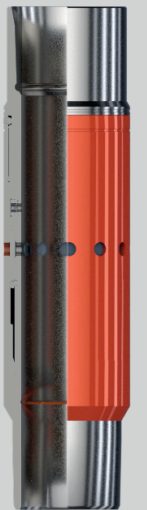

## SPECIFICATIONS

Liner size, in	4	4 1/2	4 1/2	5 1/2	5 3/4
Tool OD, in	4,65	5,24	5,75	7,09	7,09
Tool ID, in	3,46	3,90	3,90	4,80	4,80
Burst disk activation pressure, psi	4500 - 11000	4500 - 11000	4500 - 11000	4500 - 11000	4500 - 11000
Max working temperature, °F	250	250	250	250	250
Thread size*	4,0	4,5	4,5	5,5	5,75

\*Thread type, metallurgy and elastomers are as per Customer`s requirements

